



fives

VERTICAL SINGLE DISC

305 / 355 / 455 / 585

May 2021

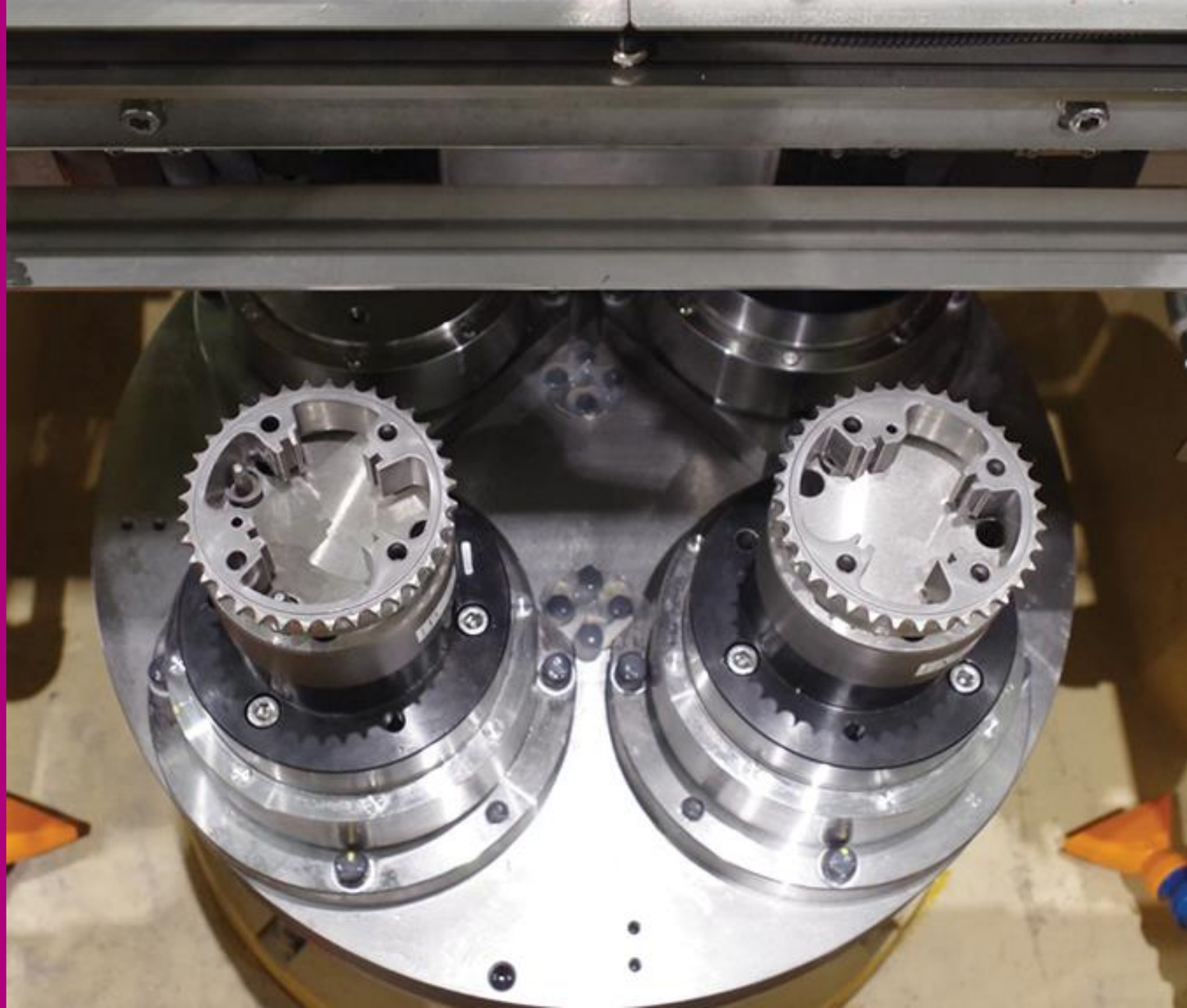

Optimum efficiency, maximum precision

The machines' cast iron structure ensures excellent stiffness, for high precision and high stock removal. The vertical single disc machines are ideal for flat surface grinding of gears, rotors and other workpieces that require precise squareness.

Our VSD grinders can also be equipped with multi-workpiece clamping, to further reduce cycle time and optimize productivity.



Flexibility with a small footprint

Our vertical single disc grinding machines have a small footprint and – thanks to the completely modular setup – these flexible systems can be engineered to meet your specific grinding requirements.

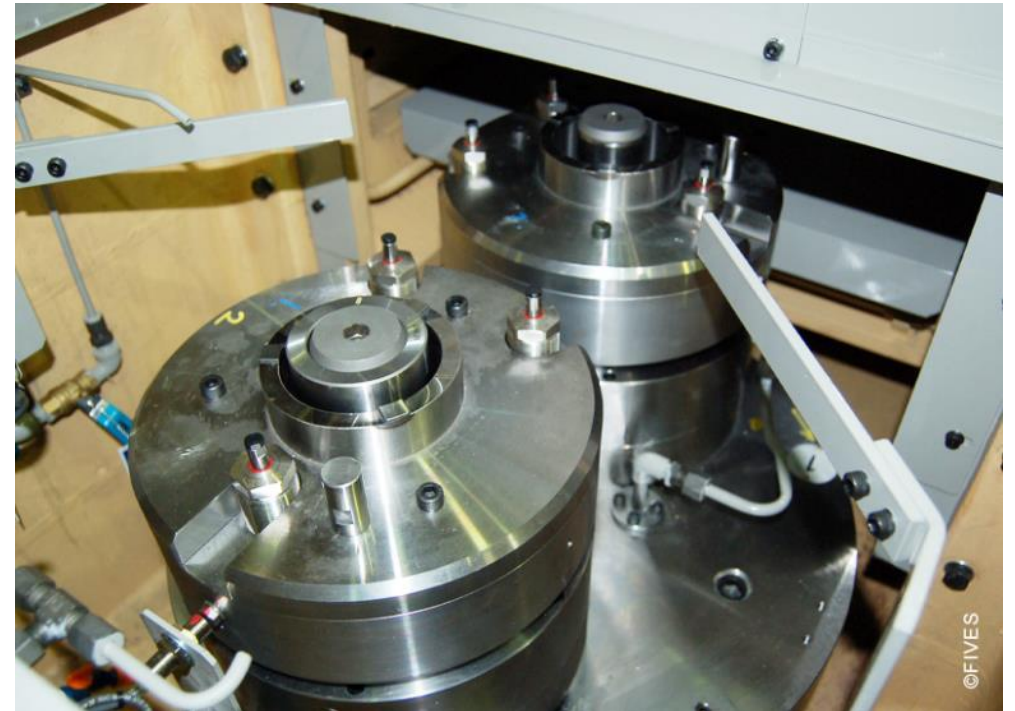

Superior machine rigidity with exceptional parallelism and flatness

Additional keys benefits include:

- A high resistance cast iron machine structure
- Grinding wheel movement that is servo-controlled
- CBN, diamond or conventional grinding wheels
- Automatic or manual loading/unloading system
- Engineered clamping system

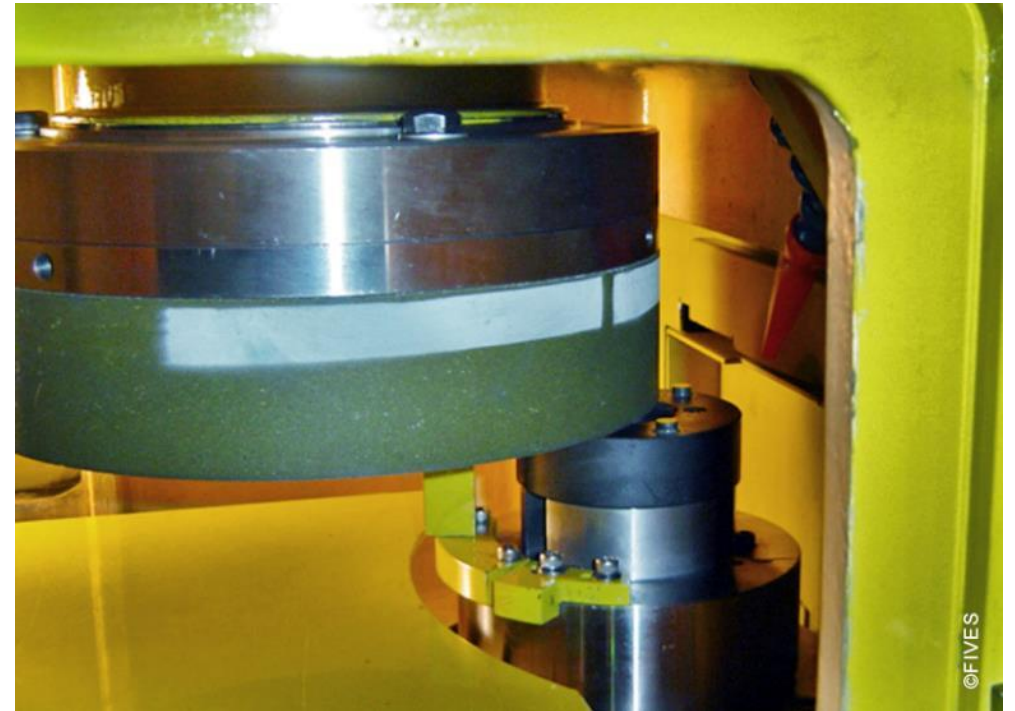

Various working modes

Our VSD machines are used to surface grind workpieces with different working methods that include:

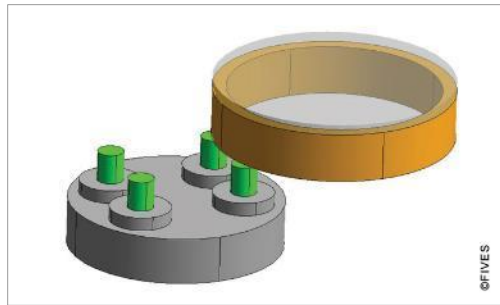

Index table work drive

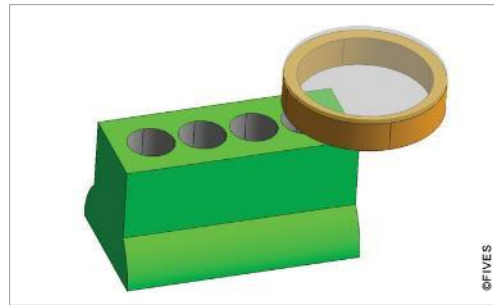

Table traverse

	VSD305	VSD355	VSD455	VSD585
Machining capacity				
Max. workpiece diameter	Joint face fixture only	225 mm	250 mm	Upon requirements
Max. workpiece thickness		125 mm	125 mm	
Wheelhead				
Wheel diameter	305 mm	355 mm	455 mm	585 mm
Max. power	7.5 kW	7.5 kW	11 kW	22 kW
Positioning precision	1 µm	1 µm	1 µm	1 µm
Coolant				
Delivery	200 l/min 2.5 bar	250 l/min 2.5 bar	250 l/min 2.5 bar	250 l/min 2.5 bar
Dimensions				
Dimensions (W x D x H)	1,400 x 1,500 x 2,540 mm	2,000 x 2,000 x 2,600 mm	1,900 x 2,640 x 2,610 mm	3,080 x 2,640 x 2,610 mm
Machine weight	5,500 kg	5,500 kg	5,500 kg	12,000 kg



fives

Industry can do it

Fives Landis Corp

16678 Halfway Blvd.
Hagerstown, MD 21740

www.fivesgroup.com